



“Roofing work”

The important points for Safety and health

Installation of scaffold (work platform)

(1) Prefabricated scaffoldings

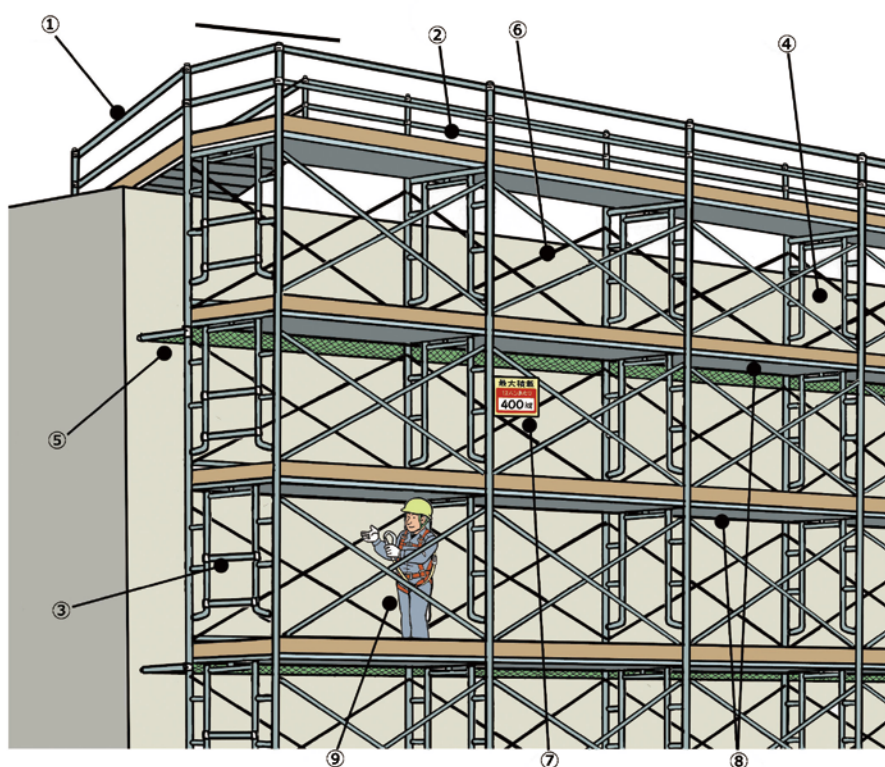

Matters to follow

1. Set up a walkway between a scaffold and a building.
2. Do not place any materials on a scaffold.
3. Install end stoppers.
4. Install vertical nets.
5. Install safety nets at each floor or toe boards on the building side.
6. Handrails are also installed on the building side.
7. Load capacity should be 400kg or less per span.
8. A working platform should be at least 40cm width, and the gap should be at most 3cm.
9. On a scaffold, use the personal fall arrest systems (fall prevention harness).

(2) Single pipe scaffold

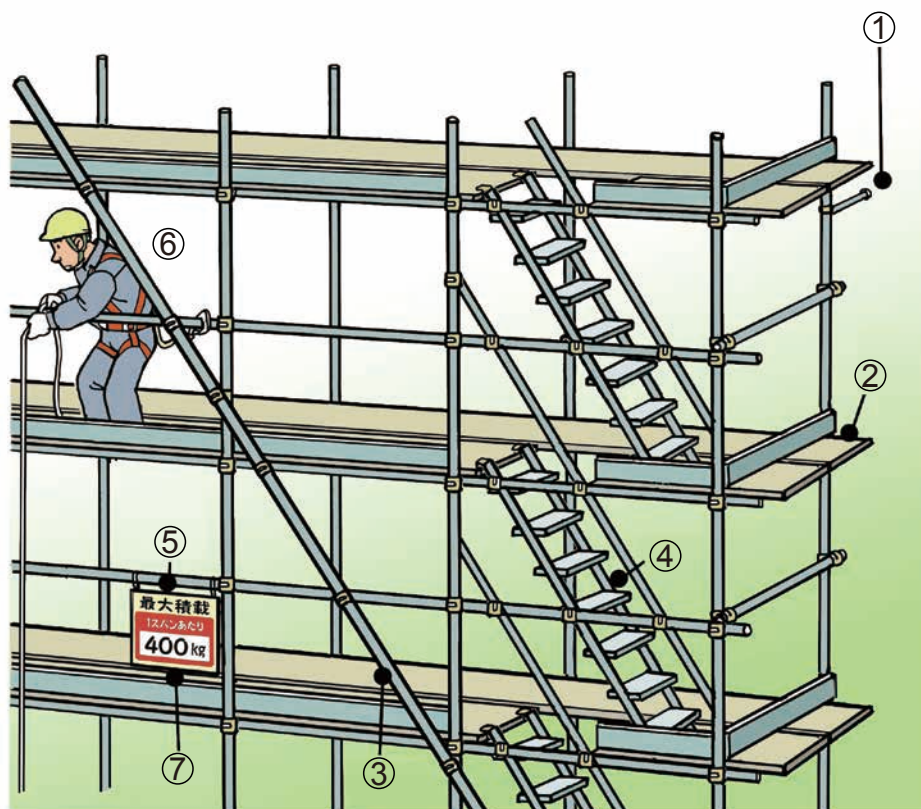

vertical pillar materials
(standard)

① wall connector

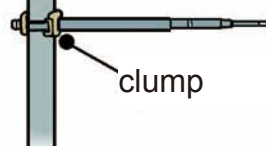

Matters to follow

1. Wall connectors should be properly installed.
2. Work platform should be at least 40cm width and the gap no more than 3cm.
3. A main brace is connected to all vertical pillar materials.
4. Uphill piers should be properly installed.
5. Display the load capacity.
6. On a scaffold, use the personal fall arrest systems (fall prevention harness).
7. The load should be 400kg or less per span.

(3) Work platform

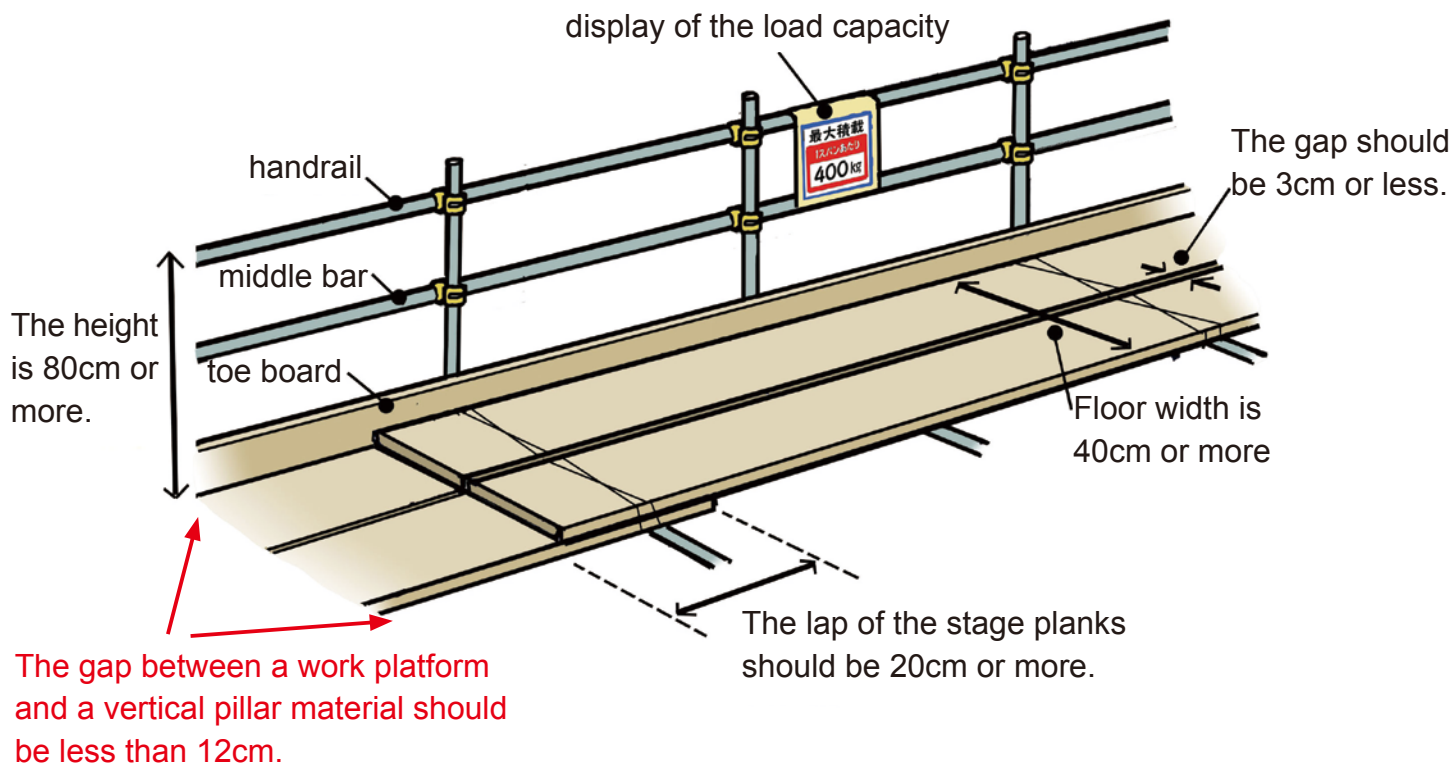

Matters to follow

1. Display the load capacity.
2. Install toe boards.
3. The width of a work platform should be 30cm or more, and the gap should be 3cm or less.
4. The gap between a work platform and vertical pillar materials should be less than 12cm.
5. Provide a sturdy handrail with a height of 85cm or more, and install a middle bar.

(4) Scaffold (base)

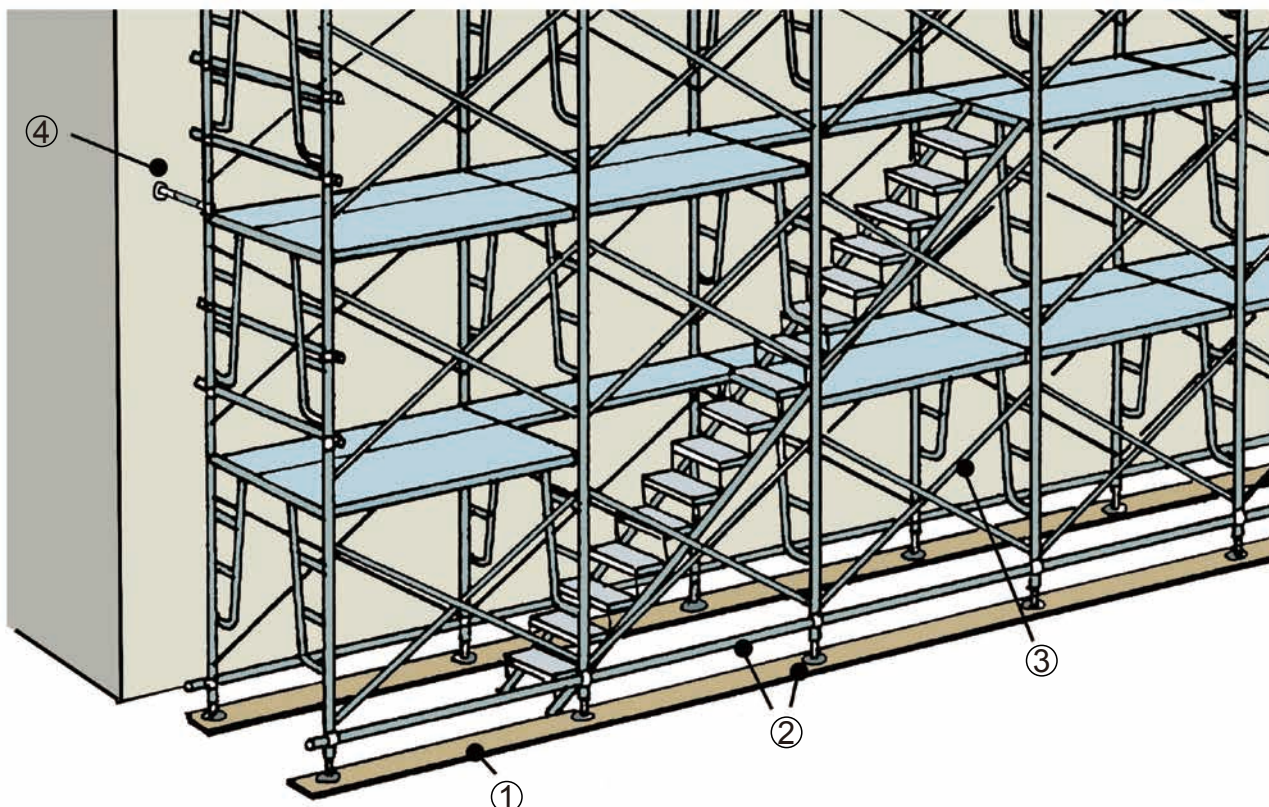

Matters to follow

1. Sole plates are provided.
2. A jack base is fixed to a sole plate with nails, or reinforcing materials connecting the lower part of the vertical members are provided.
3. Braces are provided on a whole surface.
4. Provide appropriate wall connectors.

(5) Slate roof work

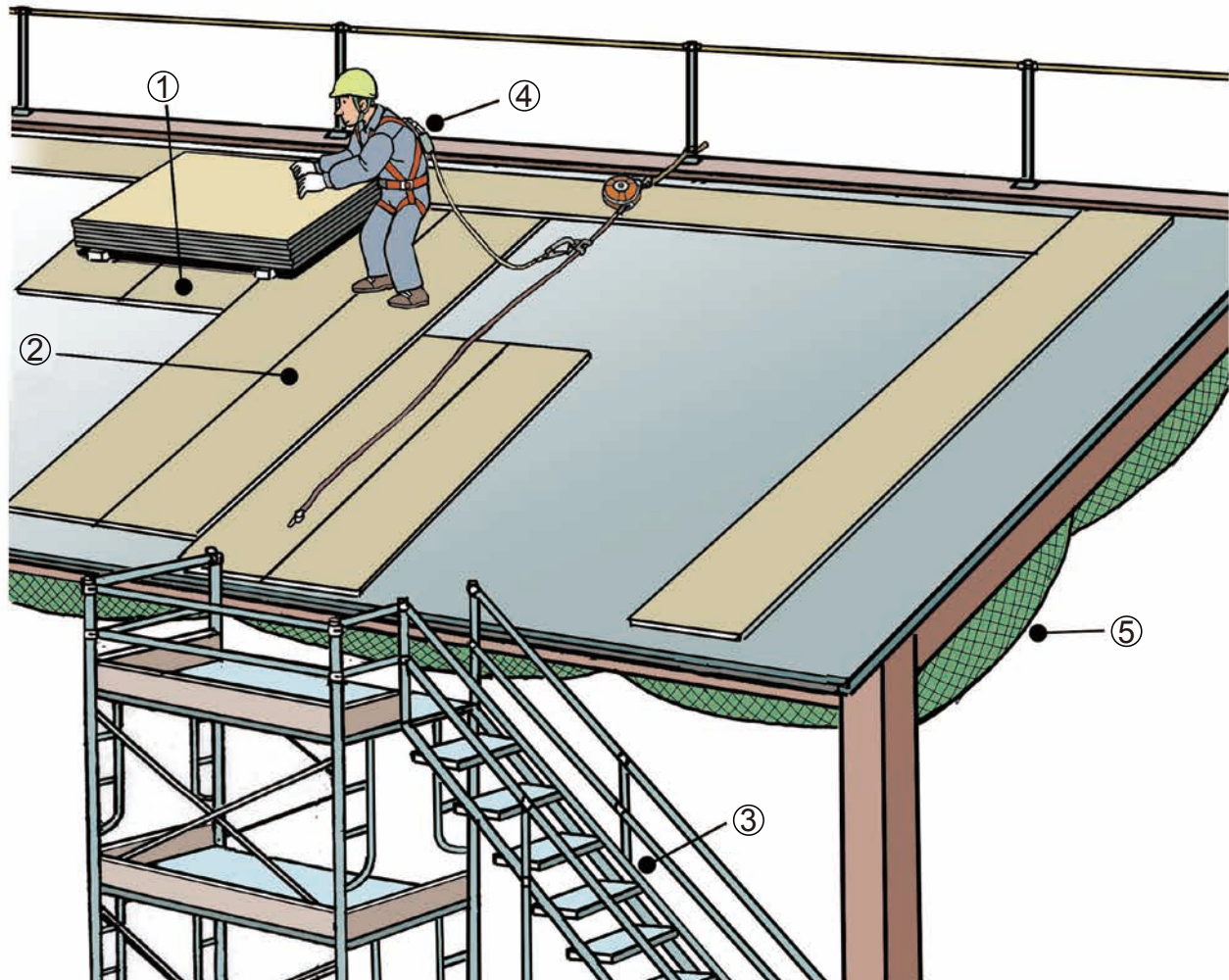

Matters to follow

1. When placing materials on a roof, lay stage boards, and place them.
2. The width of a load board should be 30cm or more.
3. Provide an uphill pier to the roof.
4. Use the personal fall arrest systems (fall prevention harness).
5. Provide horizontal safety nets.

(6) Movable ladder

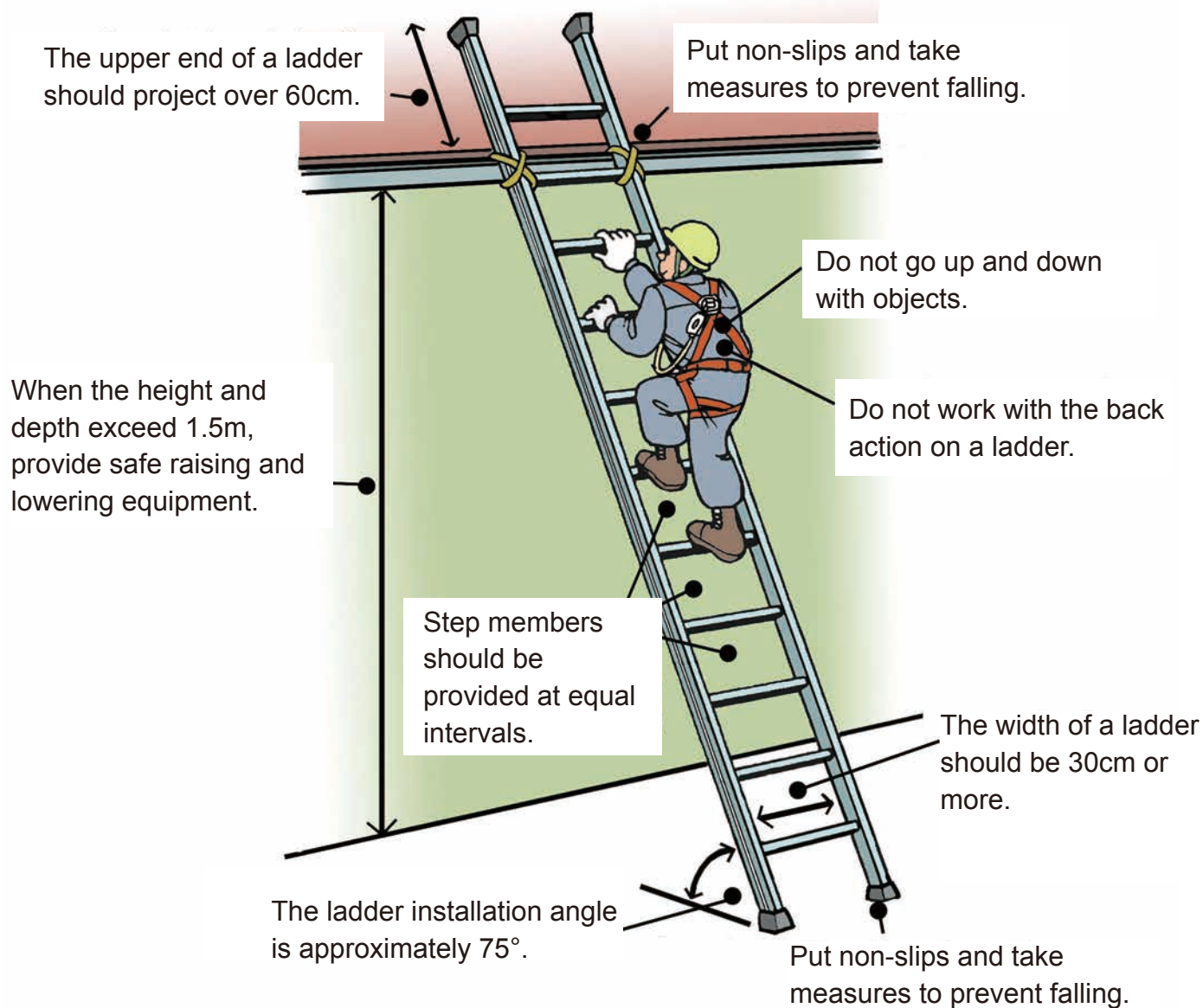

Matters to follow

1. The ladder installation angle is approximately 75 degrees.
2. The upper end of a ladder should project over 60cm.
3. Take fall prevention measures.
4. Use a ladder with a width of 30cm or more.

(7) Rolling tower

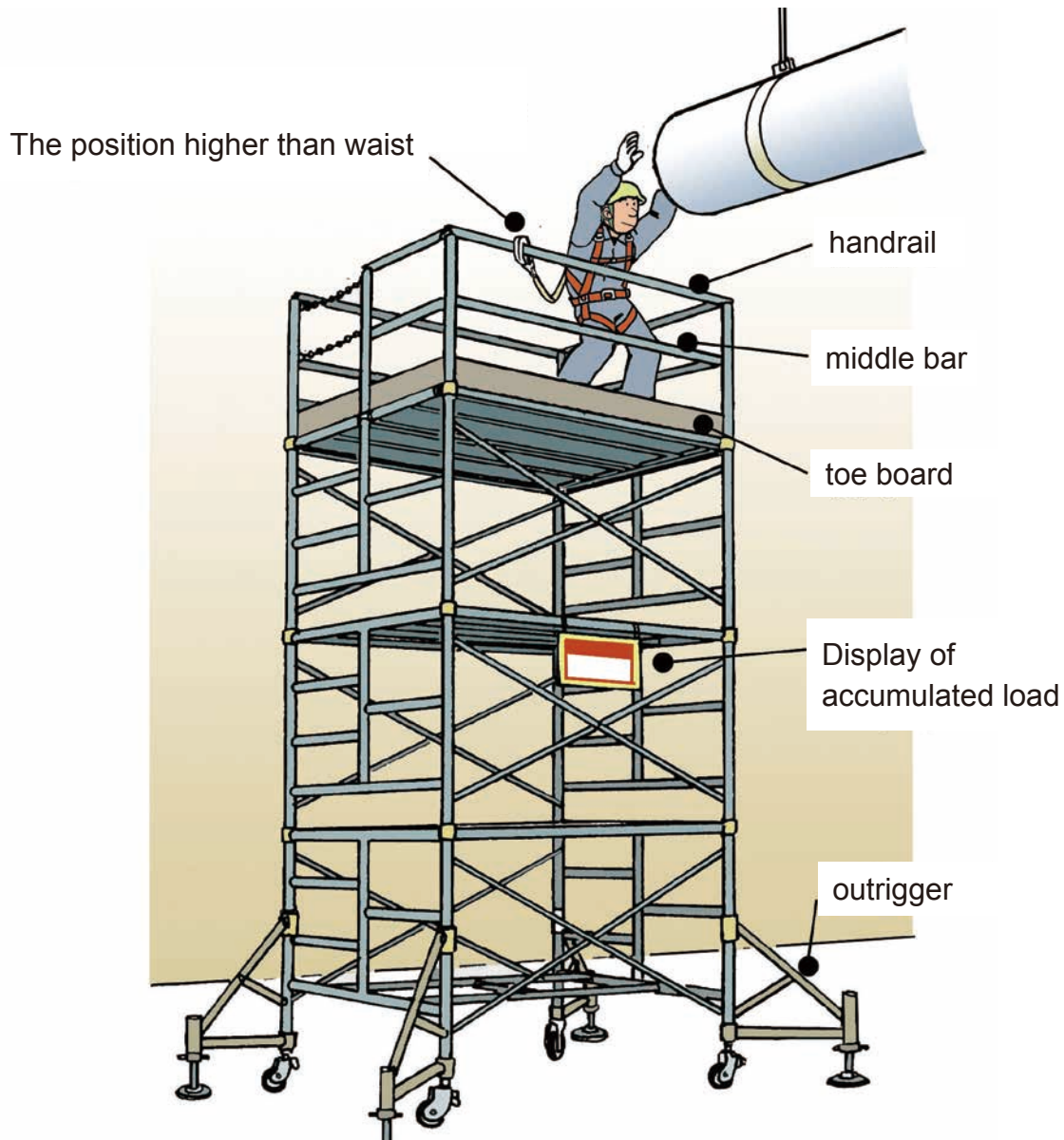

Matters to follow

1. Do not load more than the limit capacity.
2. Do not use a stepladder or a ladder on the work platform.
3. Do not move while workers or goods are on it.
4. The casters should be locked and the outriggers must be firmly fixed with jacks.

(8) Aerial work vehicle

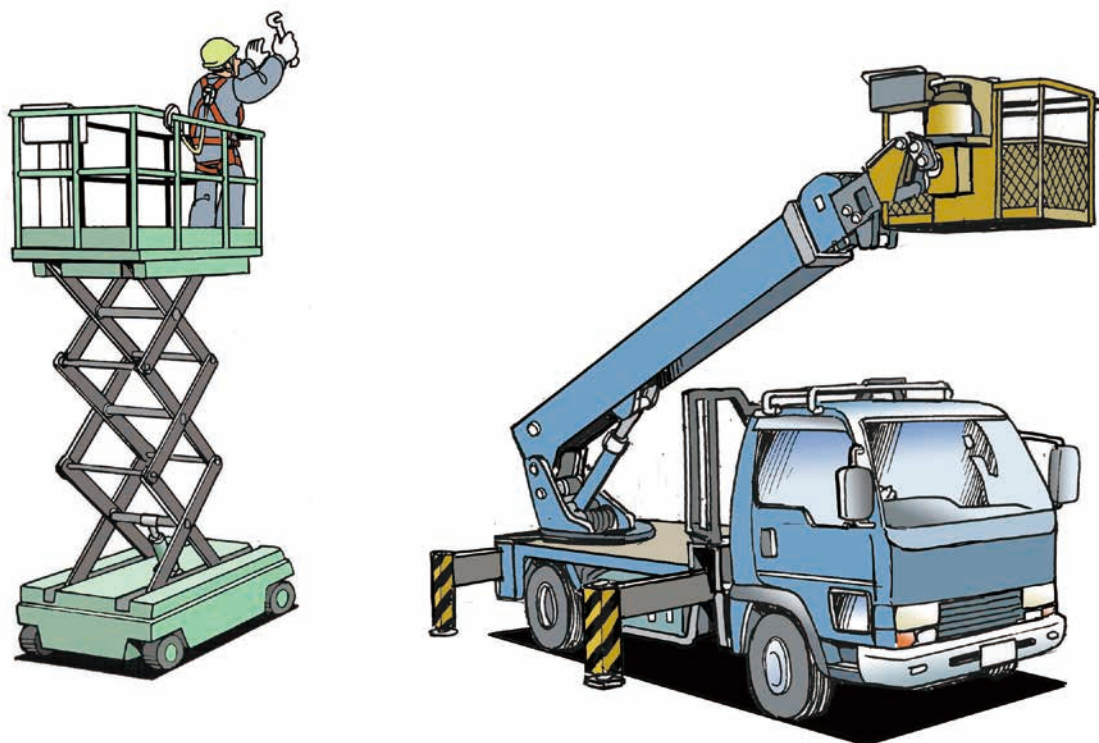

Matters to follow

1. Passengers on a work platform should properly wear the personal fall arrest systems (fall prevention harness).
2. As soon as getting on, apply a hook of the personal fall arrest system (fall prevention harness) to a handrail.
3. Moving the vehicle is carried out after lowering a work platform to the lowest position.
4. To transfer from a vehicle to another is prohibited.
5. Driving aerial vehicles requires the following qualifications.

	Skill training course	Special education
Driving aerial work vehicles with the height of the work platform is 10m or more.	○	
Driving aerial work vehicles with the height of the work platform is less than 10m.	○	○