



“Formwork construction”

The important points for Safety and health

Fall prevention device (aperture)

(1) Fall prevention device (opening, etc.)

Let's use the personal fall arrest systems (fall prevention harness)!

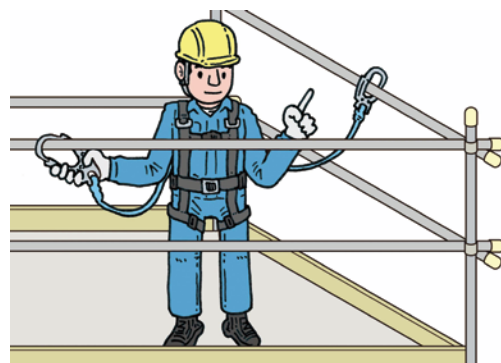

Let's install a handrail!

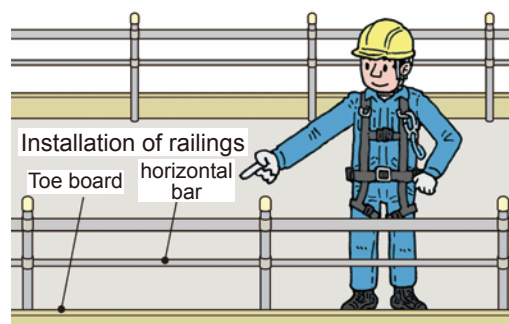

Let's install security equipments (handrails, lids, etc.) at the opening!

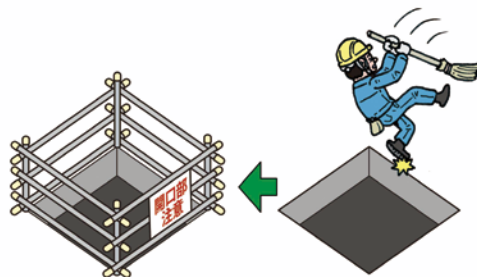

Let's maintain and follow the procedure!



(2) Personal fall arrest systems (fall prevention harness)

Personal fall arrest systems (full harness type fall prevention harness)

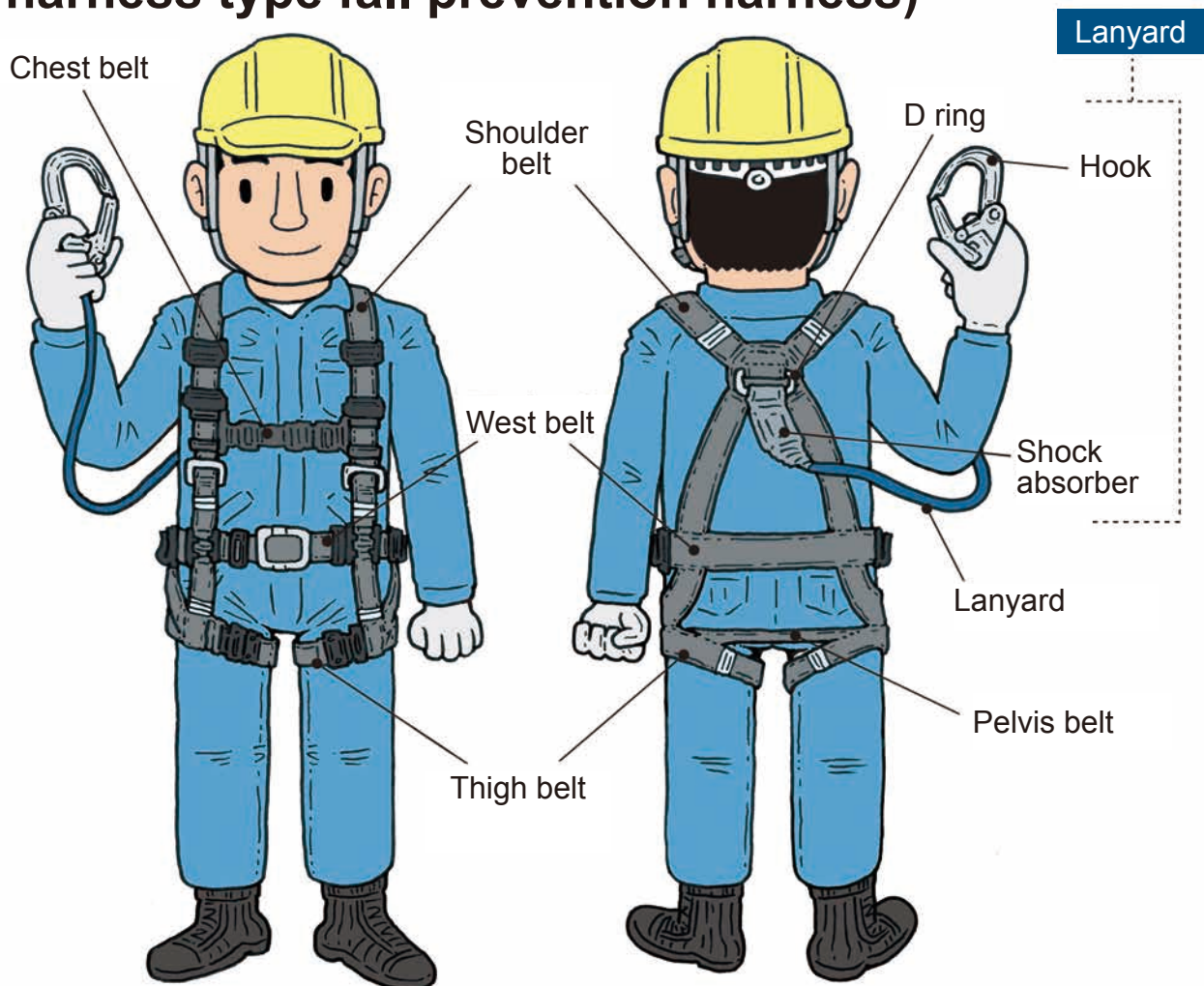

Matters to pay attention

1. Be sure to wear the personal fall arrest systems (fall prevention harness) at a height of 2m or higher.
2. Let's use the full harness type personal fall arrest systems (fall prevention harness) at a height of 5m or higher.
3. When it is difficult to provide a work platform with a height of 2m or higher, the "Special safety and health education" is required when using the personal fall arrest systems (full harness type fall prevention harness).

(3) Works around the opening

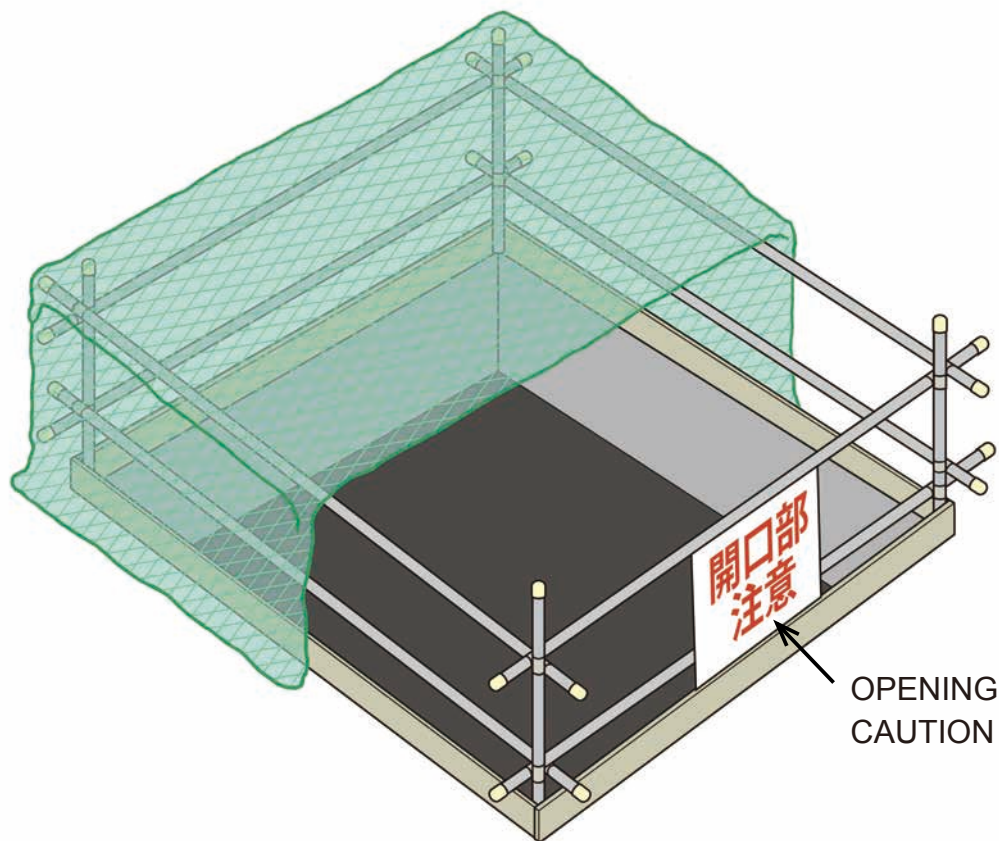

Matters to pay attention

1. Keep the lighting around the opening bright.
2. Let's confirm that a curing net is provided to prevent flying and falling.
3. Make sure that a handrail with a height of 85mm or more is provided.
4. Make sure that the toe board for falling objects is installed.
5. Do not place any materials near the opening.
6. Do not place materials on the handrail at the opening.

(4) When removing the handrail

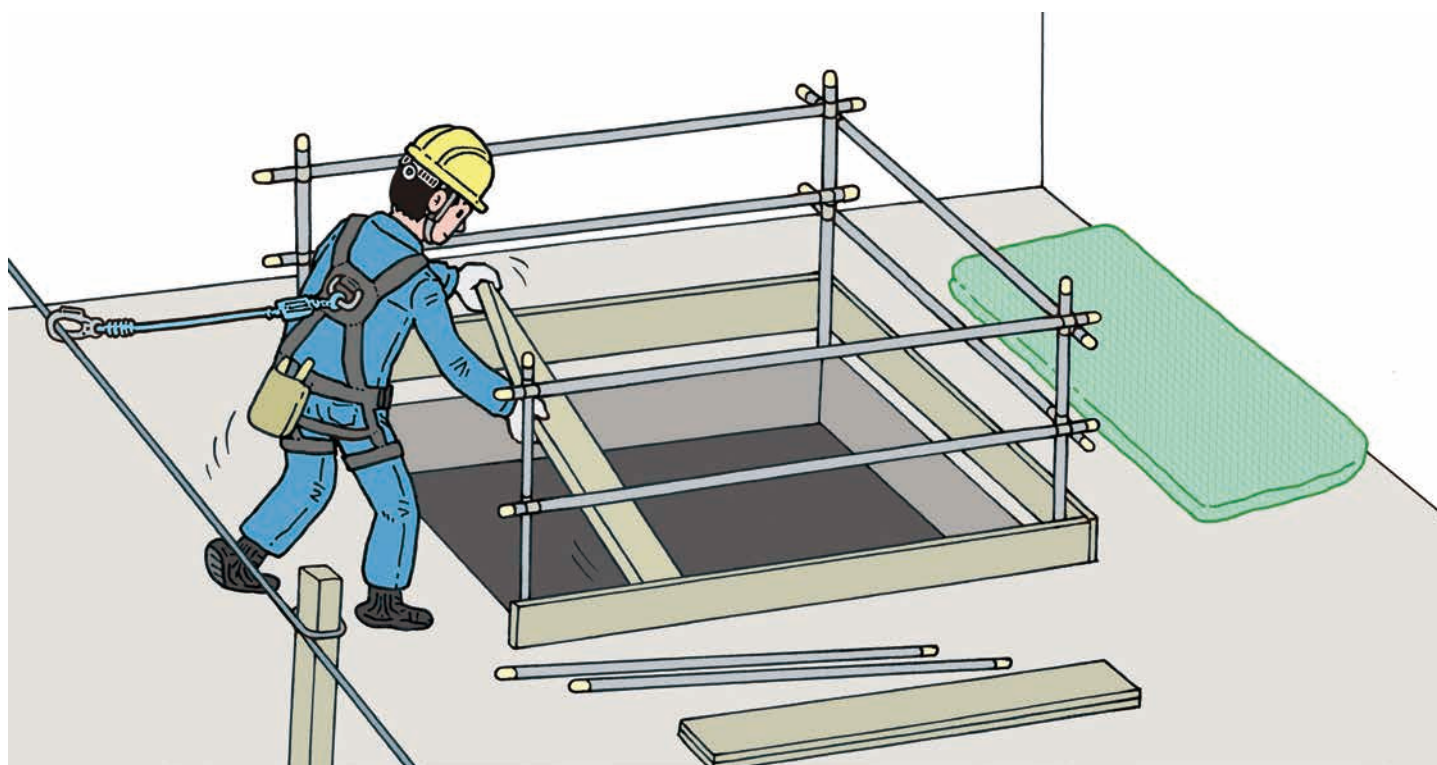

Matters to pay attention

1. When removing safety equipment such as the handrail, it is necessary to obtain permission from the main contractor.
2. Make sure to secure the installation equipment in advance when using the personal fall arrest systems (fall prevention harness).
3. Take measures to prevent entry by third parties.
4. Be sure to restore the safety equipment at the time of work interruption or at the end of work and check safety after the restoration.
5. Let's use the personal fall arrest systems (fall prevention harness) until the finishing of restoration work.

(5) Covers for the floor opening such as the inspection opening, etc.

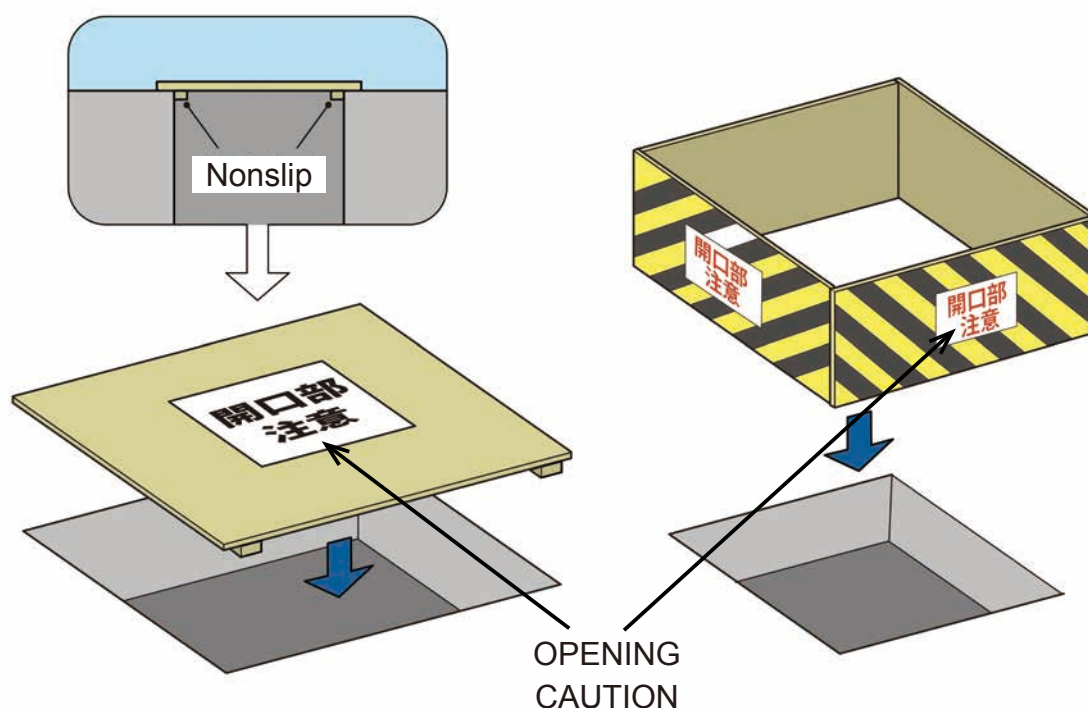

Matters to pay attention

1. When you need to work in a pit, you should enclose and display a warning around the provisional hole.
2. For small openings, take measures to prevent slipping on solid materials, and display "OPENING CAUTION!" indication on a lid to close the opening.

(6) Temporary protection handrails

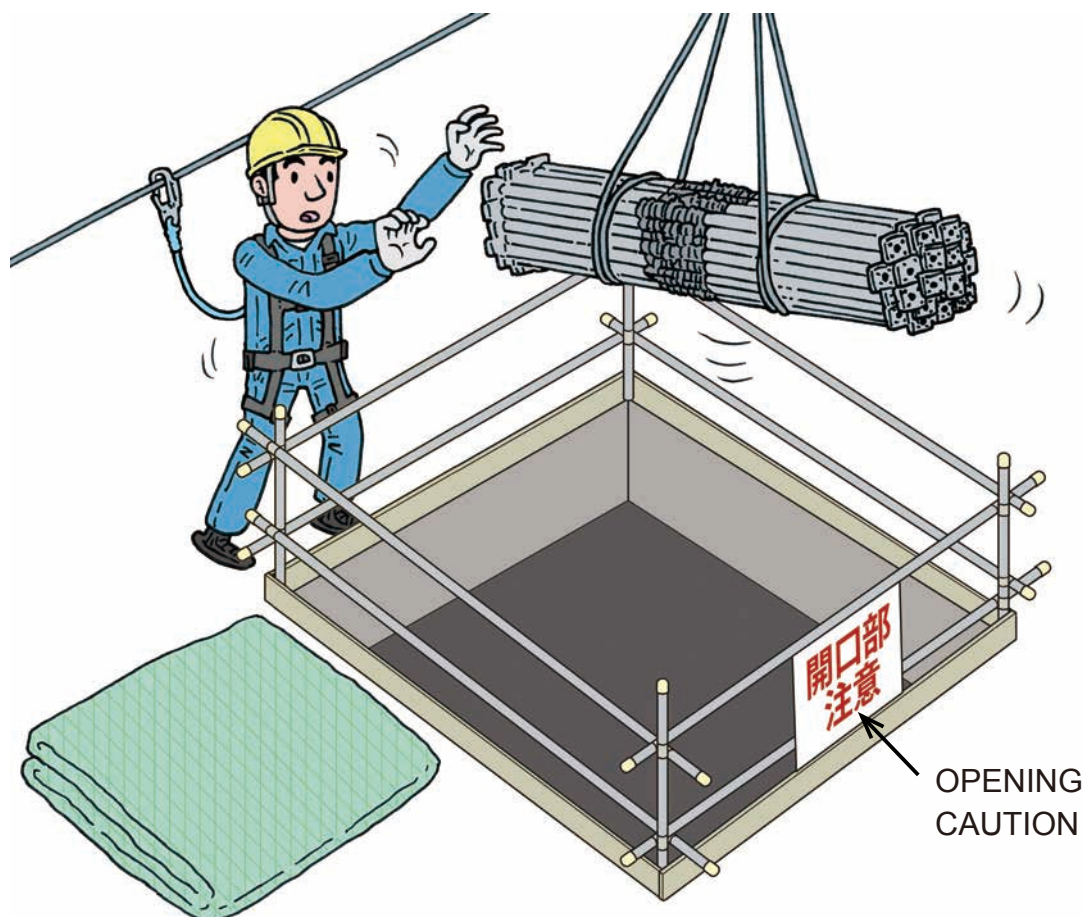

Matters to pay attention

1. In places where there is a risk of falling, such as openings and the provisional holes, be sure to install handrails, safety lines, and use the personal fall arrest systems (fall prevention harness).
2. In case the handrail makes an obstacle to the work, remove it after report to the main contractor, and restore after completion of the work.
3. Do not dismantle handrails and leave them without permission.

(7) Curing with safety nets

Safety nets are used to prevent falling of workers, tools, and materials while working on a scaffold.

Curing between floors

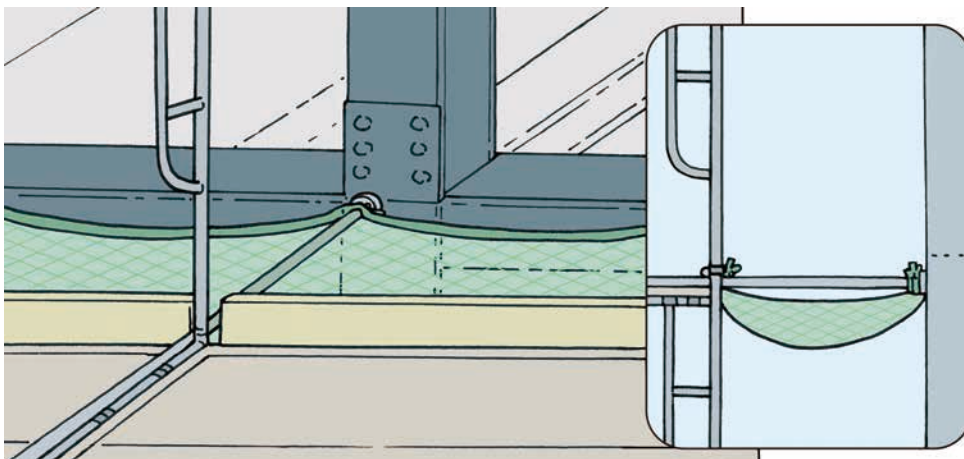

Horizontal net for openings

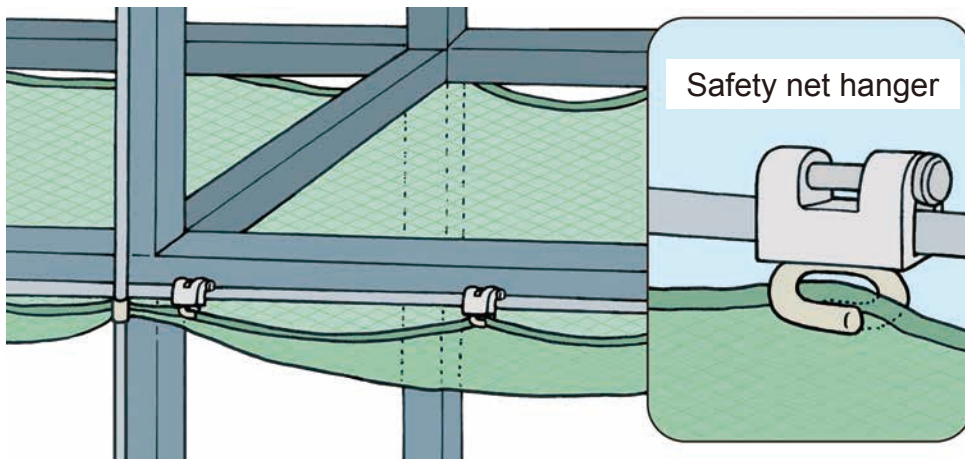

Matters to pay attention

1. Even when a safety net is installed, be sure to use the personal fall arrest systems (fall prevention harness).
2. Make sure that a safety net is strong enough and undamaged.
3. Make sure that a net is installed with proper tightness, and that there are no obstacles underneath.

(8) Seven attitudes to eliminate crashes and fall disasters

1. Think about ways to switch from working at a high place to working on the ground or on the floor where there is no risk of crashing.
2. Considering the on-site environment for the high-place work, let's use the safest and most convenient equipment.
3. Because there is a risk of crash or fall always use the personal fall arrest systems (fall prevention harness).
4. Make sure to install a fall preventive safety apparatus such as a safety block.
5. Carryout the start-up inspection of the equipment/machines and protective equipment used.
6. Elderly people and poor health workers must not work at a high place.
7. When work at a high place, the risk prediction activities at the working place or the Individual risk prediction activities must be always carried out before the work.

