

Disaster and its effects of vulnerable!

The rebuilding and support of the community

Hiroshi Takahashi
Professor of Social Policy
International University of Health and
Welfare

Stricken area of the tsunami Ofunato-shi, Iwate



The scene of refuge preparations of the nursing home before a tsunami comes.



85% of elderly people died because of a tsunami after this.

Temporary refuge using a gymnasium
It is hard environment for an elderly person, a person with a disability

プライバシーがない

見知らぬ人との
共同生活

いつ帰れるの？





最初に竣工した陸前高田市立 第一中学校仮設住宅
4月5日に抽選、36戸に対し1,160世帯が希望。
しかし、過去の経験を活かす暇はなかった

Most temporary housing



A resident does not become the structure to meet a person

It is not barrier-free, and an old resident shuts himself/herself up.

A shop and the social service are not available at a far-off place



一般的な南面平行配置形式(概念図)

**DESIGN OF TEMPORARY HOUSING
WHERE THE COMMUNITY FORMATION
IS POSSIBLE**

Example of temporary housing made in the 1930s

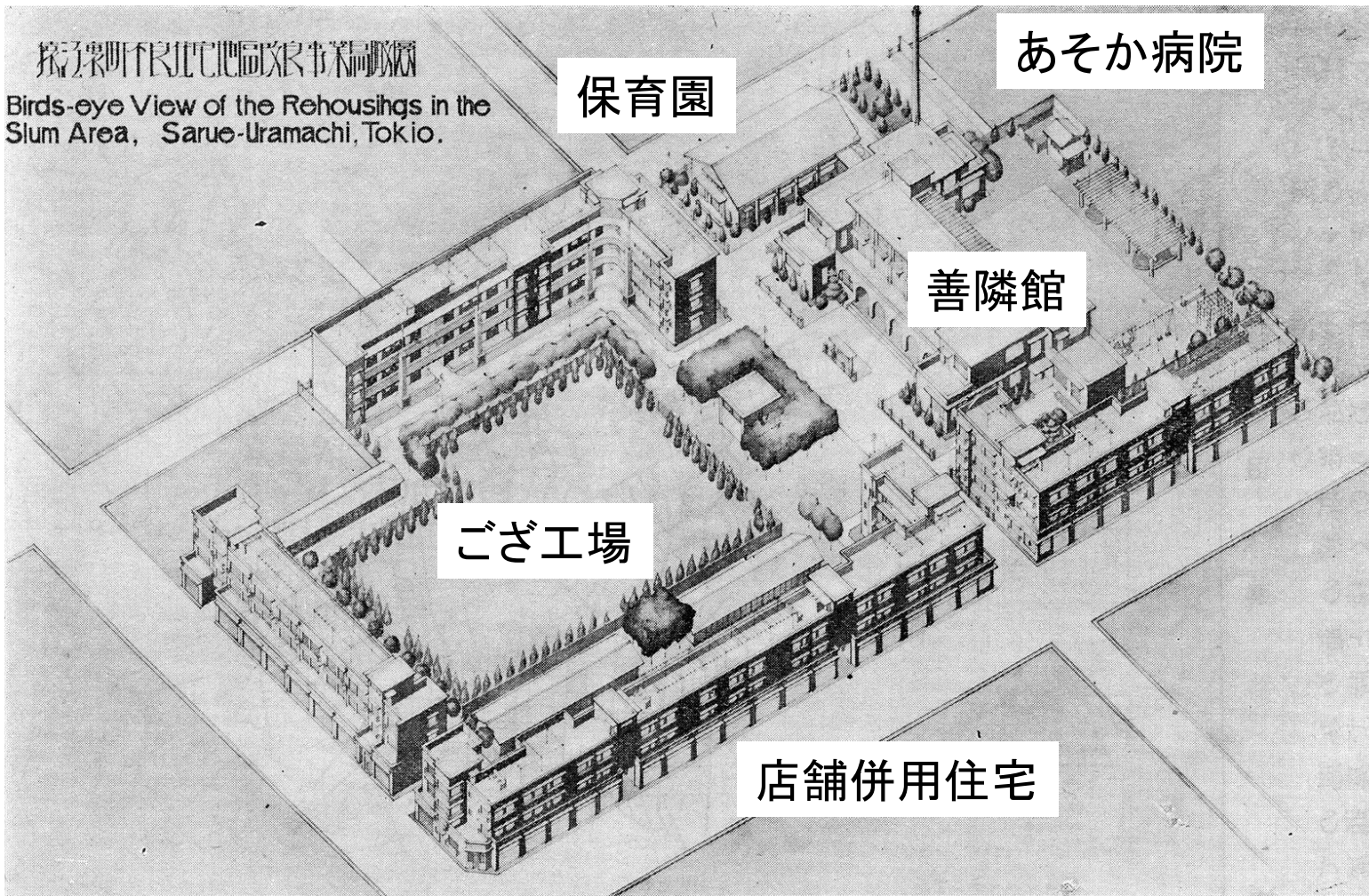

(中村寛
「住宅経営」
『高等建築学第
25巻』
常盤書房1934)

同潤会による、猿江裏町不良住宅地区改良事業(昭和2年)

Community center

Nursery school

Hospital

Workshop

Design of temporary housing where the Community formation is possible

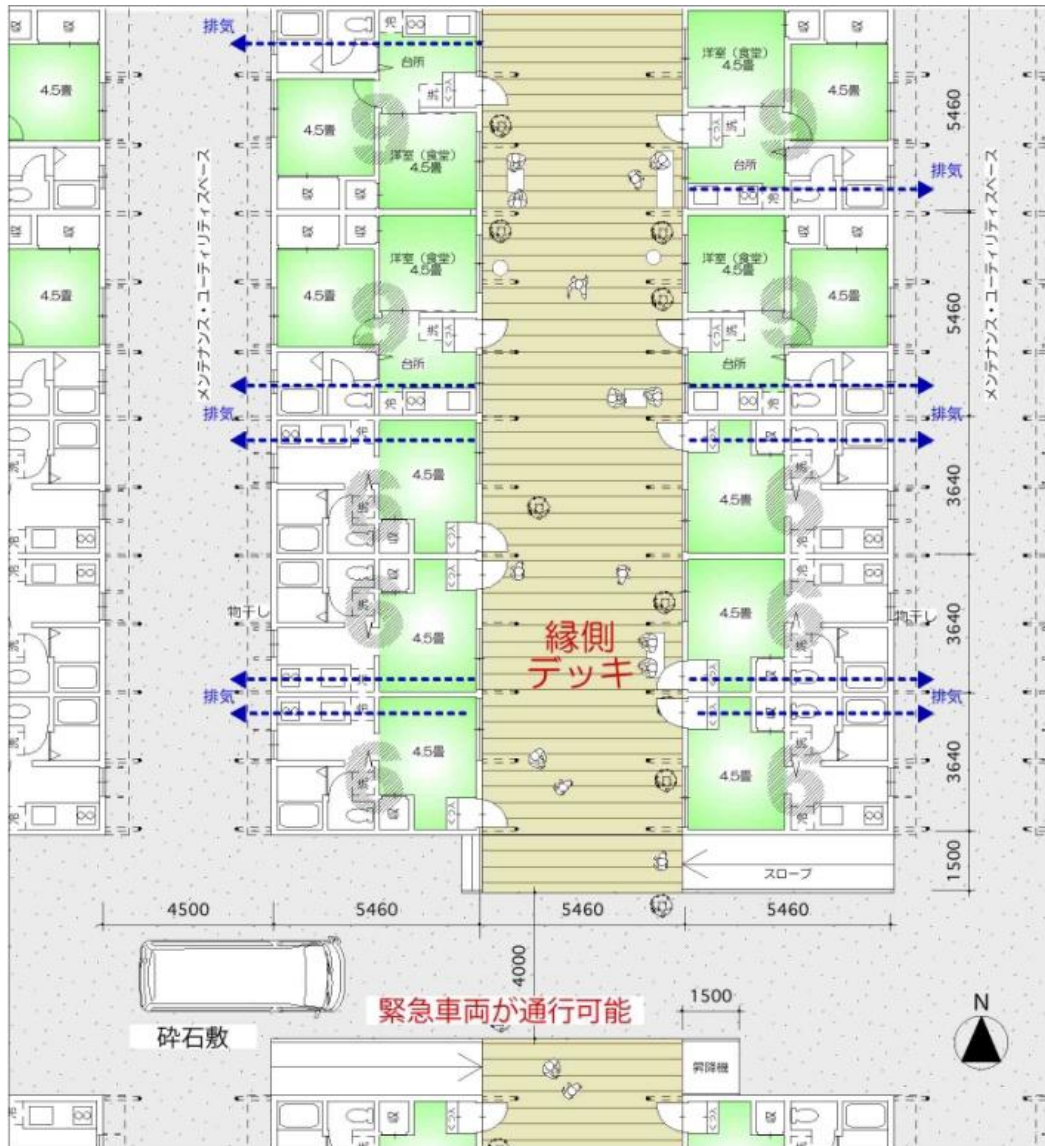

- The design which does a house facing each other
- Design of the space that is easy to create human relations
- The design which lonely death can prevent

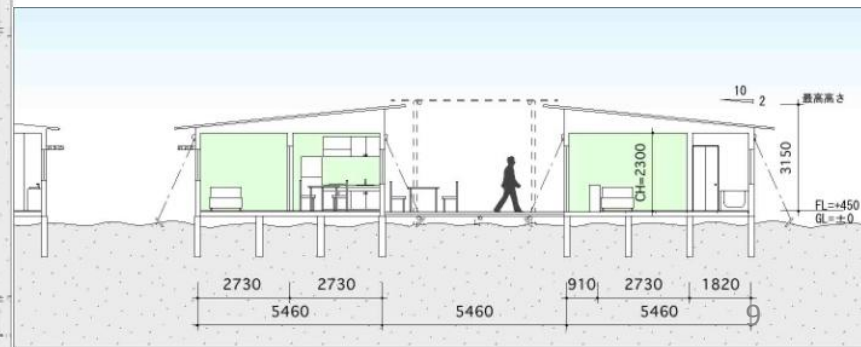

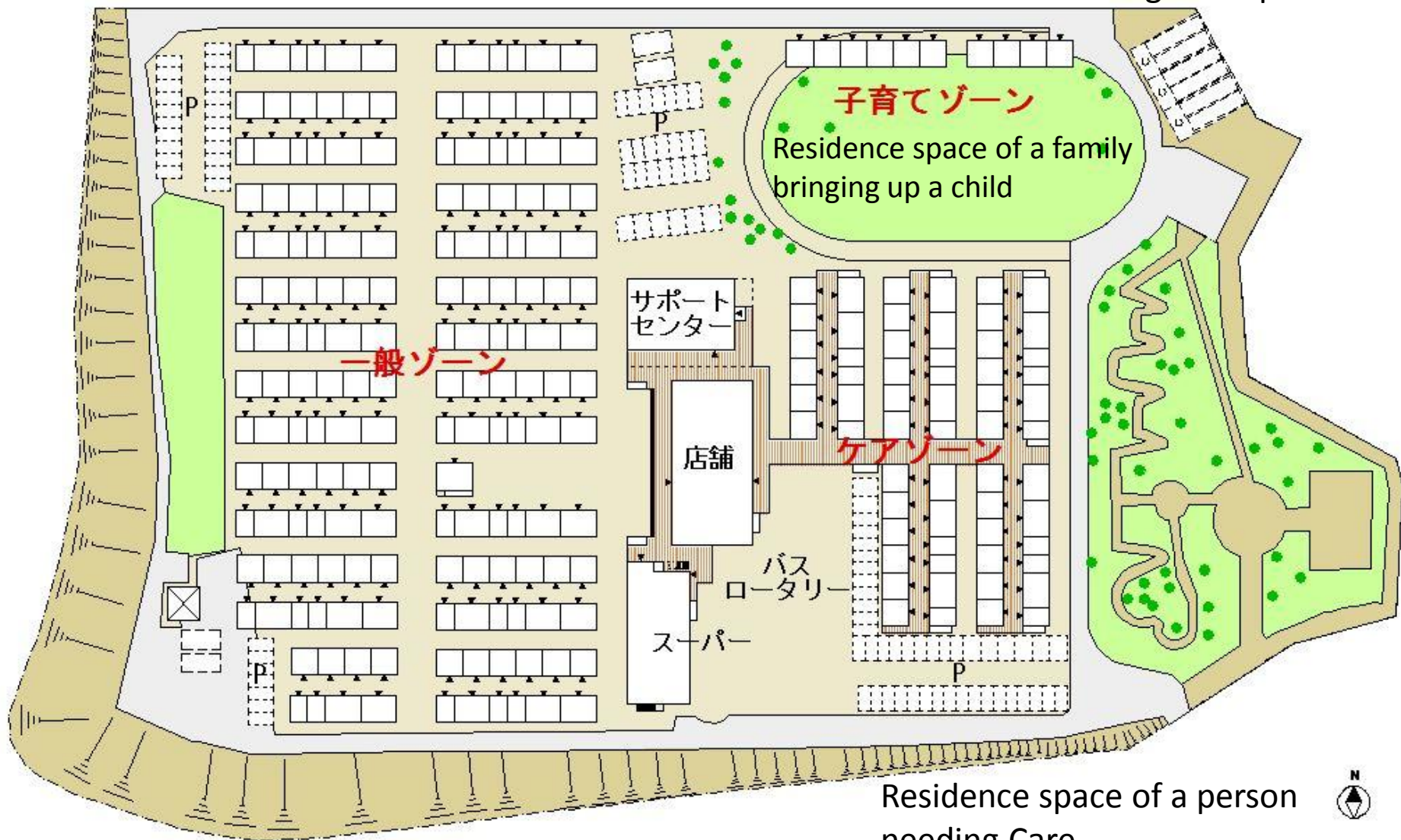

Residence space of a person
needing Care

0 40m

- 仮設店舗・スーパーの誘致
- サポートセンター内に診療所を設置
- 各部分を路地デッキでつなぐ
- 極力整地しない

	6坪	9坪	12坪	計(戸)
ケアゾーン	15	30	15	60
子育てゾーン		10		10
一般ゾーン	47	76	47	170
計(戸)	62	116	62	240

SETTING OF THE SUPPORT CENTER

Concept of Support Center



＜Support Center＞

It is installed near temporary housing

The place that has various consultations (Social Work)

Day Care , Information service , Activity,

Home Care

Care management、Visitvare, Visitnurse etc

Meal service and Life support service

Talk space

Mental care

隣地穀町公園から遠景



Residence space of the elderly person



Residence space of a family bringing up a child



The place where people come across





Residence space

The placement that the
communication between
inhabitants is possible



The appearance of the support center





サポートセンター内の診療所
2回／週
Clinic

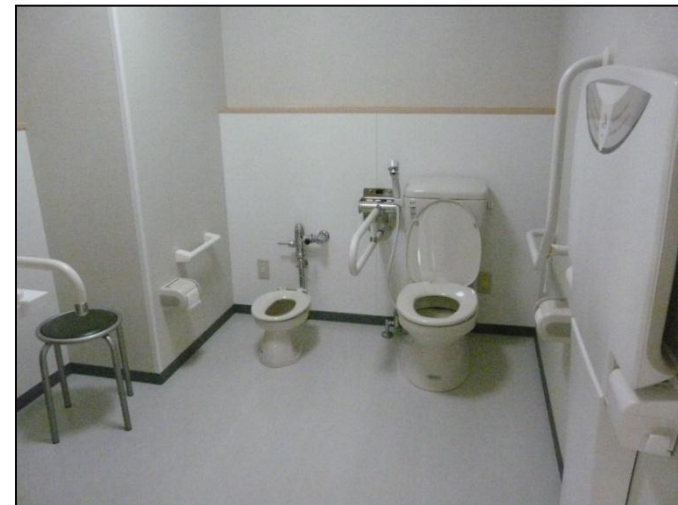

Bathroom
Restroom
(Barrier-free)

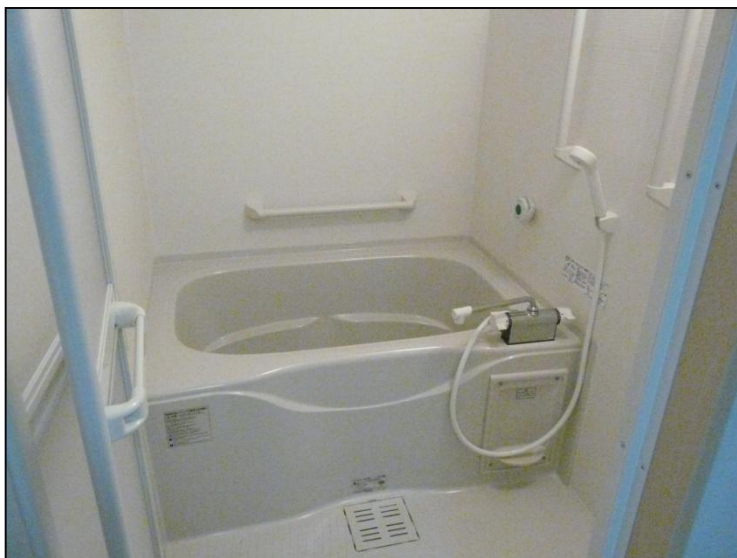



**Picturephone
(24 hours correspondence)**



Support center



Kitchen



System of the ICT
to prevent isolation

青森県社協と連携・開発した「緊急通報との一体型」
Apparatus for an emergency call and a conversation



学生とともに、立ち上げ支援 Volunteer of the student



小川晃子(岩手県立大学)、日本福祉介護情報
学会第12回研究大会シンポジウム資料

PERSONAL SUPPORT ACTIVITY IN SENDAI-CITY

CONSIDERATION AND CONCLUSION